

Other Ways to Get Involved!

1 Fundraising/ Marketing Committee

Help to raise money & awareness for the construction and maintenance of the dog park.

2 Monitoring/ Maintenance Committee

Help monitor and maintain the dog park. For more ways you can support the dog park, please contact Friends of Lynchburg Dog Park, Inc.

3 Education/ Technology Committee

Assist FLDP community education, internet development, and animal welfare outreach programs.

Join our email distribution list by sending an email to: lynchburgdogpark@gmail.com



Like Friends of Lynchburg Dog Park on Facebook

Background ...

The Friends of Lynchburg Dog Park, Inc. (FLDP) is an IRS 501(c)(3) tax-exempt, non-profit organization fundraising for the construction, maintenance, & management of a public, off-leash dog park in Lynchburg, Virginia. Donations to FLDP are tax deductible.

Working in partnership with the City, the off-leash park will be built within the existing Blackwater Creek Athletic Area. The project will be funded through donations and grants, and will be constructed in phases as monies become available.

Dogs Need Space to Run their Humans!

Dogs provide so much value, it only makes sense to give something back to these faithful friends— that's why an off-leash dog park is so important in Lynchburg! Exercise, socialization, free play, education and fun are all part of a dog's day. However, even humans garner benefits from these same activities. There are hundreds of reasons (and wagging tails) why you should support Lynchburg's only fenced, off-leash dog park. Help make the park a reality by donating or calling for more information today.



Friends of Lynchburg Dog Park, Inc.

P.O. Box 4214

Lynchburg VA 24502-0214

Phone: 434 384-1972

Email: lynchburgdogpark@gmail.com

www.lynchburgdogpark.com



DOG PARKS ADD TO THE QUALITY OF LIFE OF PEOPLE AND THEIR DOGS.

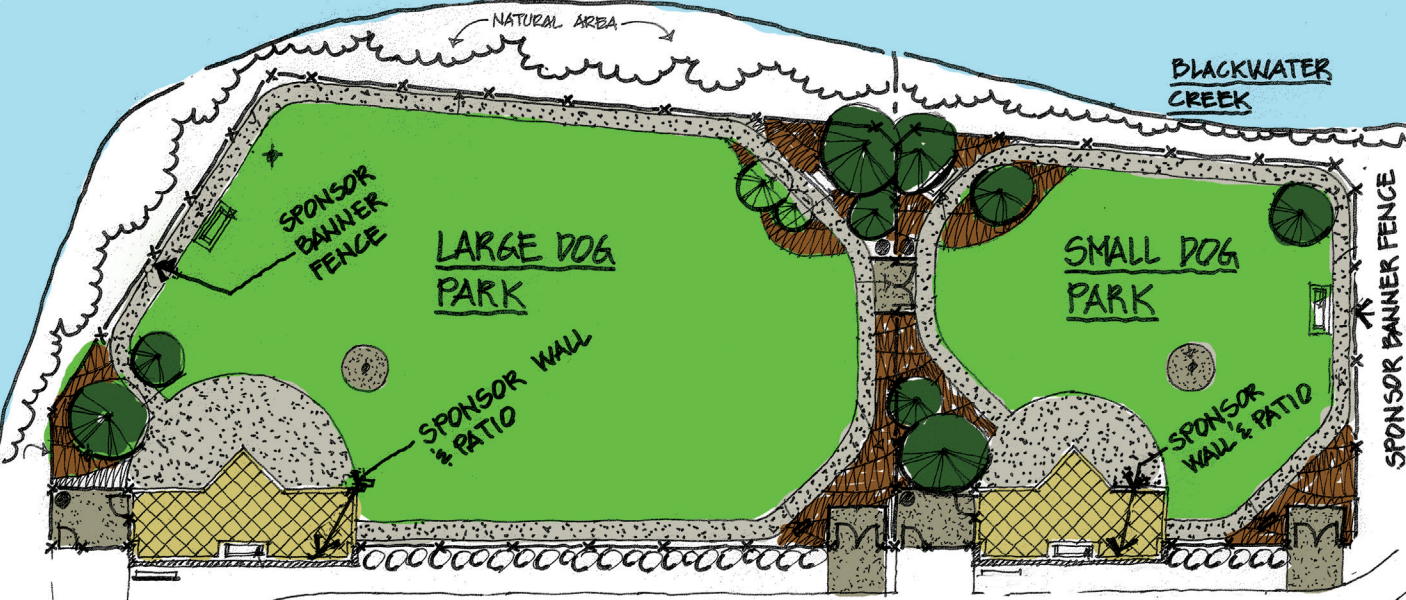

Donations of any amount are welcome.

Honor or memorialize a special human or canine friend in your life, or promote your business through a "Golden Paw" giving opportunity.

Name _____

Address _____

Phone _____

E-mail _____

Total Gift: \$ _____ Gift Level: _____

Call or check web site for availability at or above \$1000 level.

Checks may be mailed directly to the FLDP— or contact us for more information. If mailing a donation, please indicate which of the "Giving" level ranges you would like to participate in (a specific level of donation is not required). The Friends of Lynchburg Dog Park, Inc. (FLDP) is an IRS 501(c)(3) tax-exempt, non-profit organization. As with any donation, please consult your tax adviser regarding your specific tax status.

Flexible payment terms are available. Monthly or quarterly installments are welcome. Please let us know if you would prefer to donate in installments.

Friends of Lynchburg Dog Park, Inc.

P.O. Box 4214, Lynchburg VA 24502-0214

434-384-1972 • www.lynchburgdogpark.com

Thank you for your support!

You can also make a PayPal-secure **ONLINE DONATION** via our website at www.lynchburgdogpark.com.

Please indicate in the PayPal transaction message the "Giving" level and your desired message text, or e-mail that information to us separately at lynchburgdogpark@gmail.com.



GIVING OPPORTUNITIES AT LYNCHBURG'S ONLY OFF-LEASH DOG PARK

GOLDEN PAW LEVELS

Honor or memorialize a special human or canine friend in your life, or promote your business through a "Golden Paw" giving opportunity.

4" x 8" Commemorative Brick: \$100

This 4"x 8" engraved brick placed on the Sponsor Patio in either the large or small dog area can display up to 3 lines of your personal message (up to 20 characters per line); optional paw print available at no extra charge.

8" x 8" Commemorative Brick: \$200

This beautiful 8"x 8" engraved brick on the Sponsor Patio in either the large or small dog area can display up to 6 lines of your personal message (up to 20 characters per line); optional paw print available at no extra charge.

8" x 8" Commemorative Brick with Custom Graphics: \$500

A beautiful 8"x 8" engraved brick on the Sponsor Patio in either the large or small dog area can display your company logo or pet picture, with up to 6 lines of your personal message (up to 15 characters per line); optional paw print available.

One Paw: \$1,000

Annual advertising banner on Sponsor Fence in either large or small dog area (Unlimited), OR

An elegant engraved 15"W x 12"H horizontal plaque on Sponsor Wall in either large or small dog area. (16 available)

Two Paws: \$2,500

Enjoy reading a beautifully engraved personal message of your choice and/or company logo on a plaque placed on a bench, near a tree, a dog fountain or the Sponsor Wall in either large or small dog area.

Plaque sizes vary depending on location. Sponsor Wall plaques are 20"W x 30"H vertical (10 available)

- Recognition in FLDP newsletters, popular Facebook page and brochures relating to the dog park.
- Logo recognition on the FLDP website for two years.

Three Paws: \$5,000

Proudly display a beautifully engraved 36"W x 24"H horizontal plaque with your personal message and/or company logo at the Sponsor Wall. (2 available)

- Recognition in FLDP newsletters, popular Facebook page and brochures relating to the dog park.
- Recognition on FLDP dog park website page for five years.

Four Paws: \$10,000

Enjoy naming rights (per City Council approval) and display a beautifully engraved plaque with your personal message and/or company logo for the "small dog" or "large dog" play area.

- Recognition in FLDP newsletters, popular Facebook page & brochures.
- Recognition at FLDP hosted events at the dog park.
- Logo recognition on the FLDP dog park website for ten years.

Top Dog: \$35,000

Enjoy exclusive naming rights (per City Council approval) to Lynchburg's first off-leash dog park!

- Sign at the park entrance with your name or chosen name.
- Recognition in advertisements, media releases & articles.
- Recognition in FLDP newsletters, popular Facebook page & brochures.
- Banner at FLDP dog park website for the lifetime of the park.
- Recognition at FLDP hosted events.